

Female Adapter

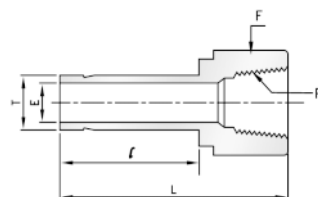
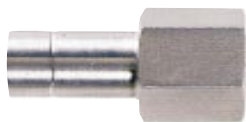

Imperial Range:

| Part No. | Tube O. D. T in | P* (NPT) | E min. | Width across flat | l | L |
|-----------|-----------------------|-------------|-----------|-------------------|-------|-------|
| | | | | F in | | |
| PFA-02-02 | 1/8 | 1/8 | 1.77 | 9/16 | 13.45 | 31.50 |
| PFA-02-04 | 1/8 | 1/4 | 1.77 | 3/4 | 13.45 | 35.30 |
| PFA-03-02 | 3/16 | 1/8 | 3.04 | 9/16 | 14.20 | 32.00 |
| PFA-03-04 | 3/16 | 1/4 | 3.04 | 3/4 | 14.20 | 35.81 |
| PFA-04-02 | 1/4 | 1/8 | 4.57 | 9/16 | 15.75 | 33.02 |
| PFA-04-04 | 1/4 | 1/4 | 4.57 | 3/4 | 15.75 | 37.10 |
| PFA-04-06 | 1/4 | 3/8 | 4.57 | 7/8 | 15.75 | 39.37 |
| PFA-04-08 | 1/4 | 1/2 | 4.57 | 1-1/16 | 15.75 | 42.50 |
| PFA-05-02 | 5/16 | 1/8 | 6.35 | 9/16 | 16.80 | 34.29 |
| PFA-05-04 | 5/16 | 1/4 | 6.35 | 3/4 | 16.80 | 37.59 |
| PFA-06-02 | 3/8 | 1/8 | 7.11 | 9/16 | 17.50 | 34.29 |
| PFA-06-04 | 3/8 | 1/4 | 7.11 | 3/4 | 17.50 | 38.10 |
| PFA-06-06 | 3/8 | 3/8 | 7.11 | 7/8 | 17.50 | 40.38 |
| PFA-06-08 | 3/8 | 1/2 | 7.11 | 1-1/16 | 17.50 | 46.73 |
| PFA-08-04 | 1/2 | 1/4 | 9.90 | 3/4 | 23.20 | 43.43 |
| PFA-08-06 | 1/2 | 3/8 | 9.90 | 7/8 | 23.20 | 45.46 |
| PFA-08-08 | 1/2 | 1/2 | 9.90 | 1-1/16 | 23.20 | 51.80 |
| PFA-10-06 | 5/8 | 3/8 | 12.70 | 7/8 | 24.70 | 48.26 |
| PFA-10-08 | 5/8 | 1/2 | 12.70 | 1-1/16 | 24.70 | 53.84 |
| PFA-10-12 | 5/8 | 3/4 | 12.70 | 1-1/4 | 24.70 | 55.37 |
| PFA-12-08 | 3/4 | 1/2 | 14.98 | 1-1/16 | 24.70 | 52.83 |
| PFA-12-12 | 3/4 | 3/4 | 14.98 | 1-1/4 | 24.70 | 54.86 |
| PFA-12-16 | 3/4 | 1 | 14.98 | 1-5/8 | 24.70 | 58.42 |
| PFA-14-12 | 7/8 | 3/4 | 17.27 | 1-1/4 | 26.70 | 57.15 |
| PFA-16-12 | 1 | 3/4 | 20.06 | 1-1/4 | 31.70 | 60.70 |
| PFA-16-16 | 1 | 1 | 20.06 | 1-5/8 | 31.70 | 64.26 |

All dimensions are in millimeters unless otherwise specified. Dimensions are for reference only, subject to change.

Female Adapter

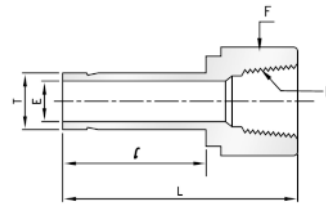
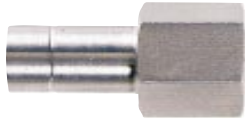

Metric Range:

| Part No. | Tube O. D. T mm | P* (NPT) | E min. | Width across flat F mm | l | L |
|------------|-----------------------|-------------|-----------|------------------------------|-------|-------|
| PFA-M03-02 | 3 | 1/8 | 1.8 | 14 | 13.15 | 31.15 |
| PFA-M06-02 | 6 | 1/8 | 4.6 | 14 | 15.75 | 32.50 |
| PFA-M06-04 | 6 | 1/4 | 4.6 | 19 | 15.75 | 37.10 |
| PFA-M08-04 | 8 | 1/4 | 6.3 | 19 | 16.50 | 37.60 |
| PFA-M10-04 | 10 | 1/4 | 7.7 | 19 | 17.50 | 38.10 |
| PFA-M10-06 | 10 | 3/8 | 7.7 | 22 | 17.50 | 40.10 |
| PFA-M10-08 | 10 | 1/2 | 7.7 | 27 | 17.50 | 46.50 |
| PFA-M12-04 | 12 | 1/4 | 9.1 | 19 | 23.50 | 43.70 |
| PFA-M12-06 | 12 | 3/8 | 9.1 | 22 | 23.50 | 46.00 |
| PFA-M12-08 | 12 | 1/2 | 9.1 | 27 | 23.50 | 52.30 |
| PFA-M18-12 | 18 | 3/4 | 13.9 | 32 | 24.90 | 54.80 |

All dimensions are in millimeters unless otherwise specified. Dimensions are for reference only, subject to change.