



MTN/1010 Series

Low cost, general purpose industrial accelerometer

Applications

- Data-collector
- Heavy industry
- Paper machinery

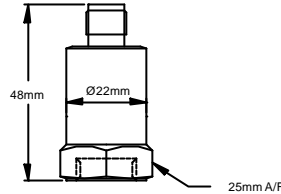

Technical Specification

Standard Sensitivity	100 mV/g $\pm 10\%$ Nominal at 80 Hz
Frequency Response	2 Hz to 10 kHz $\pm 5\%$ (-3 dB at 0.8 Hz)
Mounted Base Resonance	16 kHz (nominal)
Isolation	Base non-isolated
Dynamic Range	$\pm 80g$
Transverse Sensitivity	Less than 5%
Electrical Noise	0.1 mg max
Current Range	0.5 mA to 8 mA
Temperature Range	-25 to 120 °C
Bias Voltage	12 Volts DC (nominal)
Case Material	Stainless steel
Mounting Torque	8 Nm
Weight	110 gms (nominal)
Sealing	IP65
Connector	T.N.C.
Options	Various connector assemblies and other sensitivities.

ORDER CODE PART No	MOUNTING	xx =OPTIONAL SENSITIVITY RANGE AVAILABLE (+/- 10%)
MTN/1010-xx MTN/1010Q-xx	1/2 UNF FEMALE QUICK FIT FEMALE	10 mV/g 30 mV/g 50 mV/g
FOR OTHER MOUNTINGS SEE OVER PAGE.		

Mounting Adapters and Studs

Studs and Grub Screws



Male Studs		
Product Code	From	To
MS036	1/4" - 28 UNF	M6
MS039	1/4" - 28 UNF	10 - 32 UNF
MS067	1/4" - 28 UNF	M8
MS068	1/4" - 28 UNF	1/4" - 28 UNF
MS124	1/4" - 28 UNF	M10
MS132	1/4" - 28 UNF	M12

Quick Fit Adapters

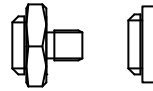

Quick Fit (Q/F)		
Product Code	From	To
MS001	Q/F Male	Glue Base
MS002	Q/F Male	M8 Male
MS003	Q/F Male	M10 Male
MS004	Q/F Male	1/4" - 28 UNF
MS006	Q/F Male	M6 Male

Other Adapters

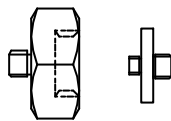

Mounting Adapters		
Product Code	From	To
MS005	Q/F Male	1/4" - 28 UNF Female
MS007	Q/F Male	10 - 32 UNF Female
MS008	Q/F Male	M8 Female
MS011	1/4" - 28 UNF Male	Q/F Female
MS013	1/4" - 28 UNF Male	Glue Base
MS033	1/4" - 28 UNF Male	Q/F Female
MS038	Q/F Male	M8 Conical Male
MS061	1/4" - 28 UNF Male	10 - 32 UNF Male
MS079	1/4" - 28 UNF Male	Q/F Female
MS106	Q/F Male	M10 Female

Isolation		
Product Code	From	To
MS034	1/4" - 28 UNF Male	1/4" - 28 UNF Female
MS093	Q/F Male	M8 Male

System Connection

